

*The Big South Fork's Most Prestigious Address*



In the spectacular upper Cumberland of Tennessee lies ROCKHOUSE Ranch, a true horseman's paradise, encompassing 600 acres, adjoining the Big Southfork National River and Recreation Area with hundreds of miles of riding trails.

- Gated Community
- Underground Utilities
- City Water
- Parcels from 5 to 20 acres from \$65,000
- Desirable Protective Covenants
- Attractive Financing Available
- Best trail riding experience anywhere!

We offer the ultimate in outdoor splendor and the best land values in the Southeast. Only a few parcels remain in this most unique setting.

A Rare Opportunity—Don't Miss It.

## Warner Land Company

A REAL ESTATE MARKETING FIRM

**Don G. Warner**

*Principal Broker*



877-482-6196

423-215-3166

Email: [warner04@frontier.com](mailto:warner04@frontier.com)



Shown by appointment only. For more info, log on to: [www.RockhouseRanch.com](http://www.RockhouseRanch.com).

-  GREAT SECTIONS STILL AVAILABLE
-  SECTIONS NO LONGER AVAILABLE

**BIG SOUTH FORK NATIONAL RIVER & RECREATIONAL AREA**

RESERVED



**Big South Fork's Most Prestigious Address**  
[www.rockhouseranch.com](http://www.rockhouseranch.com)

**BIG SOUTH FORK NATIONAL RIVER & RECREATIONAL AREA**

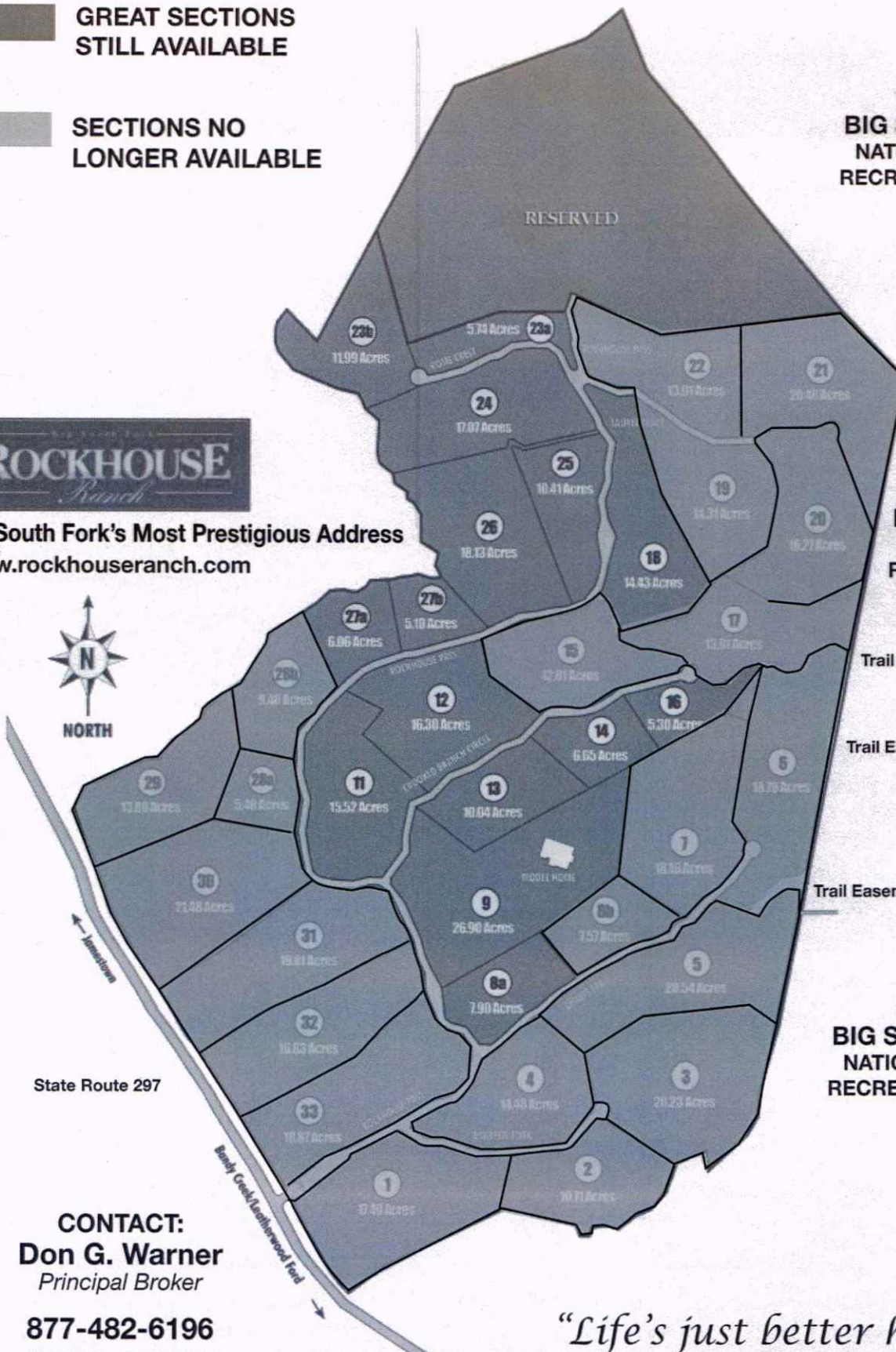

Trail Easement

Trail Easement

Trail Easement

**BIG SOUTH FORK NATIONAL RIVER & RECREATIONAL AREA**

State Route 297

**CONTACT:**  
**Don G. Warner**  
 Principal Broker

**877-482-6196**  
**423-215-3166**

Email: [warner04@frontier.com](mailto:warner04@frontier.com)

*"Life's just better here!"*